

# TECHNICAL DATA SHEET

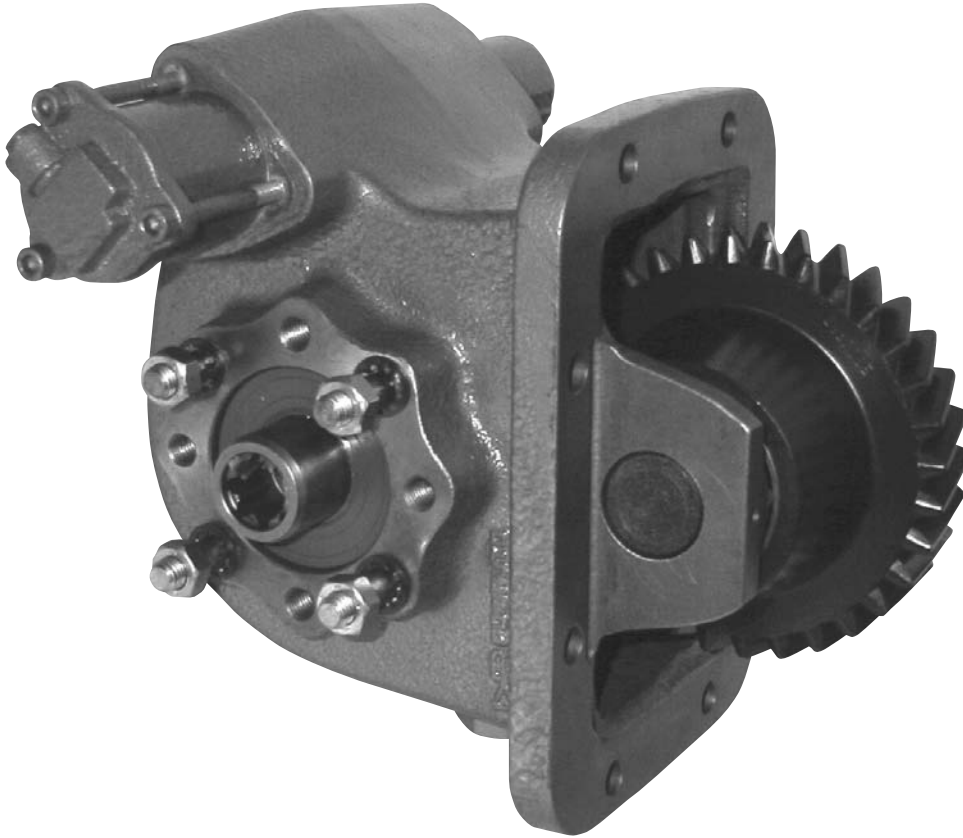

## 8-BOLT DEEP REACH SIDE MOUNT POWER TAKE-OFF

The 371 series PTO is designed for Isuzu MLD transmissions with non standard eight bolt openings.

The PTO is supplied with an extra deep reach gear to mesh with the countershaft gear deep inside the transmissions.

### SUITS:

Certain Isuzu transmissions

## 371 SERIES POWER TAKE-OFF

### PRODUCT FEATURES

- **BETWEEN 0.72 AND 1.02:1 RATIO**  
Depending on transmissions, for high flow pump requirements.
- **MULTIPLE OPERATING OPTIONS (AIR, CABLE)**  
For greater flexibility in operation.
- **HIGH CAPACITY IDLER BEARINGS**  
For longer life.
- **VERSATILE DESIGN**  
For ease of installation.
- **VARIETY OF OUTPUTS**  
For wide variety of pumps.

DEALER:

# TECHNICAL DATA SHEET

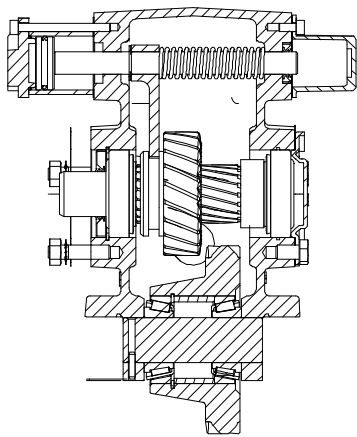
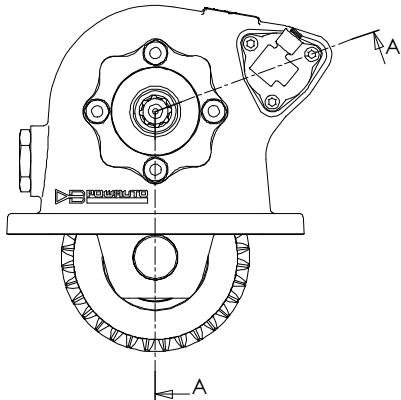

## PTO DESIGNATION CODES

### 371 series PTO

**PA 371 SE L11 A 13 \***

#### Identifier

PA = PTO Side mount

#### PTO series

371

#### Gear Type

SE

#### Build

L = Left side of trans

1 = Selector to top

1 = Centre to front - Position of gear in transmission

#### Engagement Type

A = Air

E = Electric / Air 24V

#### Output Type

08 = 8T Powauto Hydraulic Spline

09 = 14T 12/24 30° Spline + 35x60 Flange

10 = 14T 12/24 30° Spline + 1310 Series Flange

11 = 14T 12/24 30° Spline + 1410 Series Flange

13 = 13T SAE B Hydraulic Spline + 77122

#### Manufacturers Code

A = With pressure switch

B, C etc. (internal use only, if required)

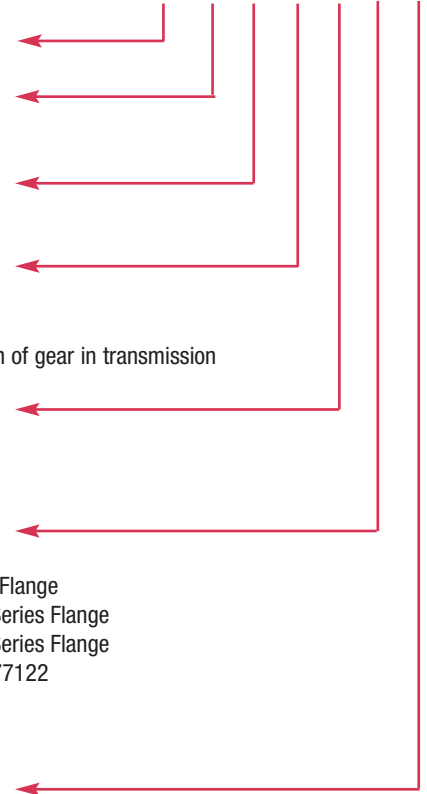

For full details refer to owner's manual

## Technical Specifications

### Rating for intermittent Service

|                                 |           |
|---------------------------------|-----------|
| Torque (Nm / lb ft)             | 363/267   |
| Power @ 500 rpm (kW / hp)       | 19.0/25.4 |
| Power @ 1000 rpm (kW / hp)      | 37.9/50.8 |
| Output Shaft Rotation           | Opposite  |
| Approximate Bare Mass (kg / lb) | 11/24.2   |
| Mounting Kit                    | MK1176A   |

**For full details refer to Powauto or consult your applications book.**

#### Spare parts:

Seal Kit:

Bearing Kit:

Mounting Gasket Kit:

Seals & gaskets (minor overhaul)

Bearings/seals and gaskets (major overhaul)

*Gears and shafts sold separately*

SK076

BK076

GK020